

Fuel Quality Sentry FQS20 series

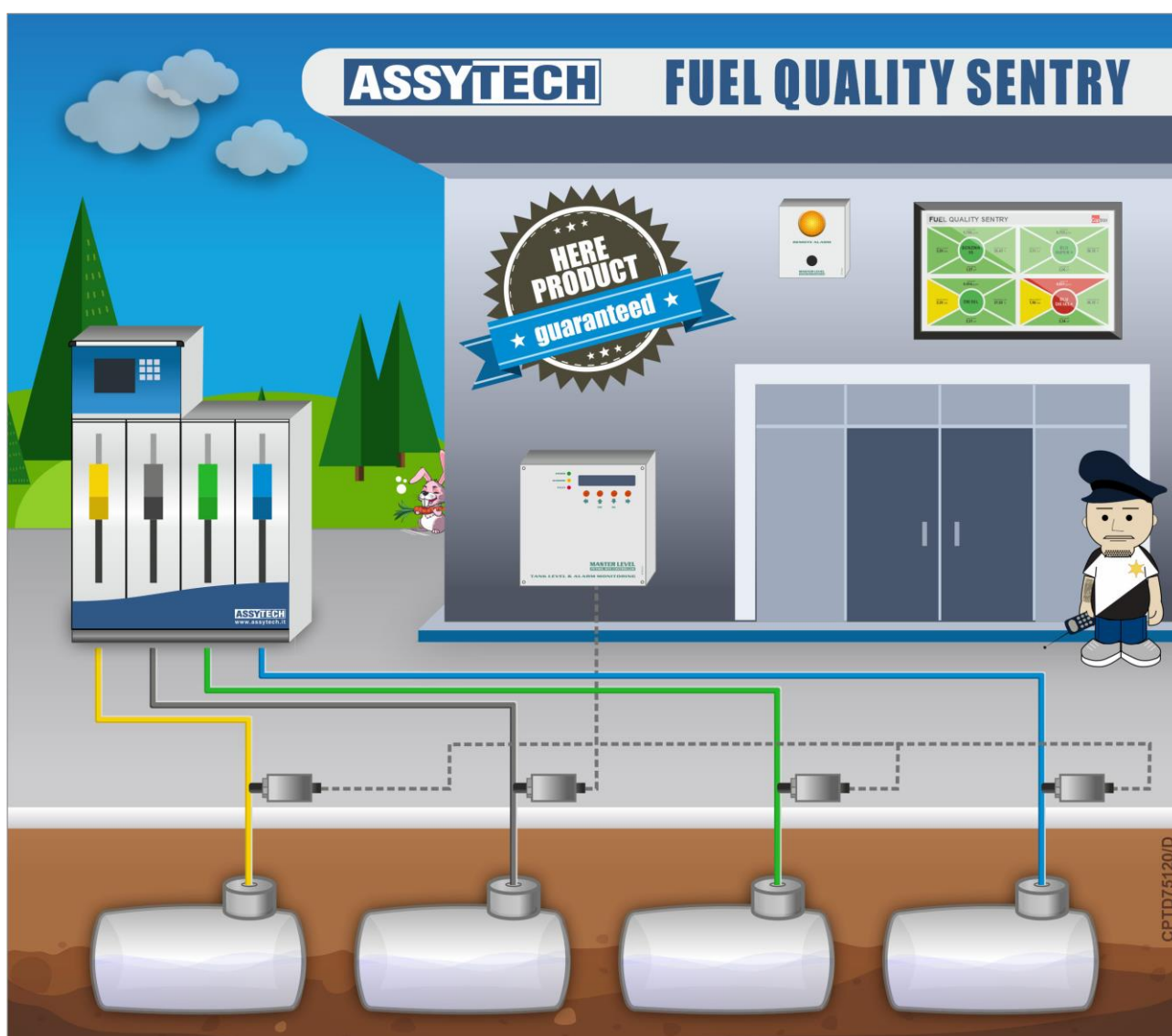

System description

The Fuel Quality Sentry FQS20 system has been designed to guarantee the customer the quality of the fuel delivered at service stations.

Special sensors installed on the suction lines of the dispensers verify the main characteristics of the same such as **density, viscosity, dielectric and temperature**.

The AT19810 control unit connected to the sensors analyses the fuels supplied and in the event that these have parameters that begin to depart from the standards, it activates the acoustic alarm, alerting the operator, if the situation worsens, the fuel dispenser is automatically blocked.

The AT08219 interactive monitor connected to the AT19810 control unit displays a synoptic where the parameters that determine the quality of the dispensed product are highlighted in real time. A solution that can also be used to emphasize the attention to the service of that area: in fact, the results can be displayed to inform the customer about the quality of the product served.

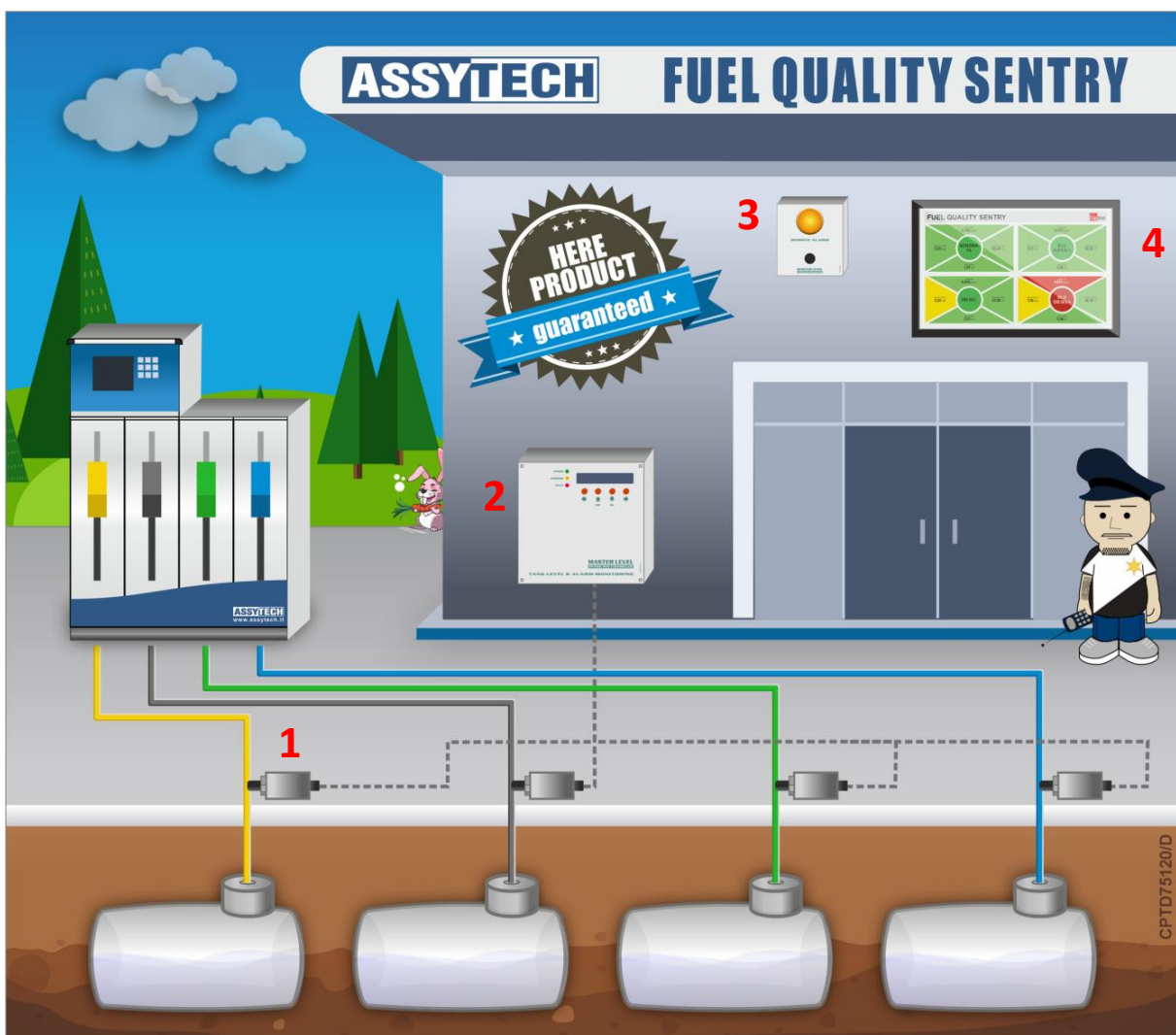

Reference parameters

Product	Density 15°C (Kg/m ³)			Viscosity (mm ² /s)			Dielectric contant			Temperature (°C)
	Min	Max	Ril.	Min	Max	Ril.	Min	Max	Ril.	Ril.
Gasoline 95 RON	720	775	746	-	-	0,38	-	-	2,29	24,3
Gasoline 100 RON	720	775	752	-	-	0,38	-	-	2,43	26,16
Diesel	820	845	843	2	4,5	3,38	-	-	2,29	27,19
Diesel +	820	845	831	-	-	3,73	-	-	2,21	26,25
Oil SAE 10-40	-	-	761	-	-	83,67	-	-	2.29	27,7
Exhausted oil	-	-	766	-	-	55,17	-	-	1.77	28,8

Dimensions

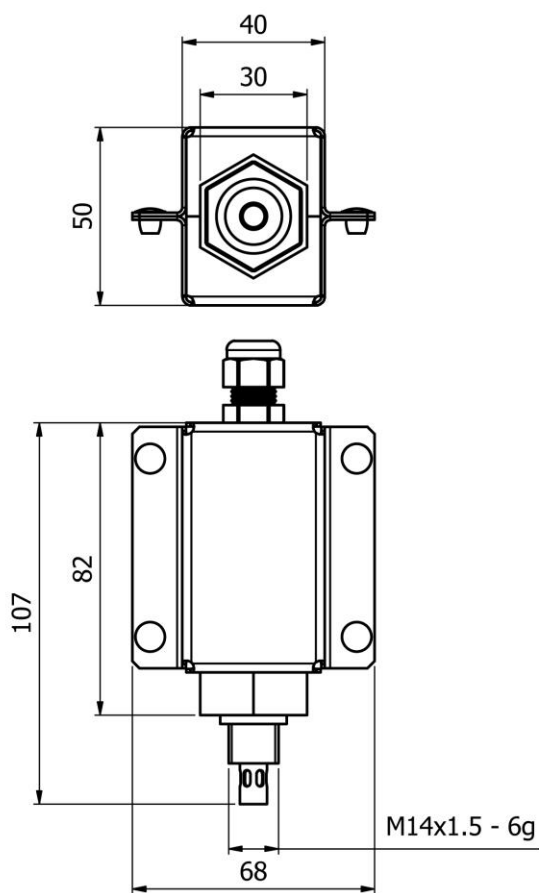

Accessories

AT10418	Reducer F14X1,5 - M 1/2"
AT10518	Reducer F14X1,5 - M 1/4"

Code

AT04914/XX*	Product quality sensor
-------------	------------------------

/XX: cable length (m, standard 3 m)

Data management control unit

Data management control unit received from the product quality sensor.

The GSM / GPRS module, mounted on a special slot (host 1), allows you to receive alarm messages or request product stock from one or more service or storage stations.



Technical characteristics

• Power supply	100-240 VAC 50/60 Hz
• Consumption	25 VA
• Operating temperature	-10°C ÷ +40°C
• Level measurement probes connectable	8
• Smart sensors connectable	16
• On/off auxiliary sensors connectable	4/8
• Relay output	4/8
• Relay output flow	500 mA 24 VCC
• Remote serial connection	RS232/RS485
• Auxiliary serial connection	RS232 LAN modem GSM/GPRS radio wireless
• Remote printer connection	RS232
• Housing	In fire-painted metal
• Dimensions	310X95H260 mm

Code

AT19810	/TYPE	/DATA OUTPUT	/ALARMS
	A: v. base	N: RS232/RS485 *	04/04: 4 input/4 output
	B: with display and keyboard	S: second RS232	08/08: 8 input/8 output
	G: with graphic display	L: LAN	
	O: open frame	G: modem GSM/GPRS	
		R: radio wireless 433 MHz	
		W: radio wireless 169 MHz	

* Possible with the AT13600/K converter to be purchased separately

Remote alarm

Electro-acoustic signalling device for outside.
The signal is turned off only when the alarm is reset.



Technical characteristics

• Power supply	12 VCC 150 mA
• Flash frequency	1 Hz 2 W
• Light emission	0,75 J
• Sound level	85 dB
• Operating temperature	-20°C ÷ +40°C
• Protection class	IP20

Code

AT15507	Remote alarm
---------	--------------

/XX: cable length (m, standard 3 m)

Visualization monitor

Data visualization monitor with integrated management CPU complete with tactile keyboard.



Technical characteristics

• Power supply	12 VDC
• Consumption	Max 2,5 A
• Video	15.6" Touch Monitor Led
• Resolution	1366X768
• Input data	RS232/RS485 (depending of the model)
• Operating temperature	-10°C ÷ +40°C
• Relative humidity	5% ÷ 95% (without condensing)
• Dimensions	418x249x84 mm

Code

AT08219	/FIRMWARE	/VERSION	/COMMUNICATION TYPE
	02: FQS20	1: Wall mounting with monitor 2: Wall mounting without monitor	/1: RS485